

DT1 : MISE EN SITUATION

L'entreprise General Motors STRASBOURG produit des transmissions automatiques ou boîtes de vitesses automatiques (BVA) pour véhicules à propulsion : BMW, OPEL, LAND ROVER, etc...

Le volume de production moyen est de 1500 boîtes par jour.

Boîte de vitesses automatique à 5 vitesses

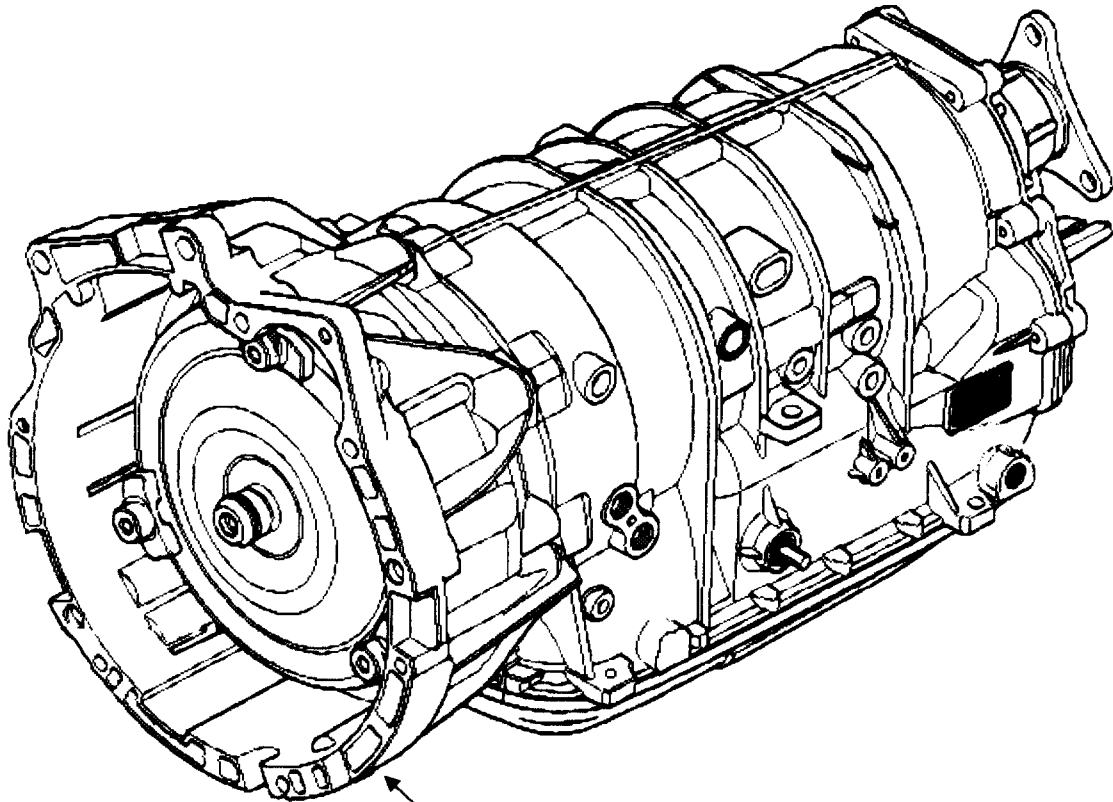

Objet de l'étude : Carter

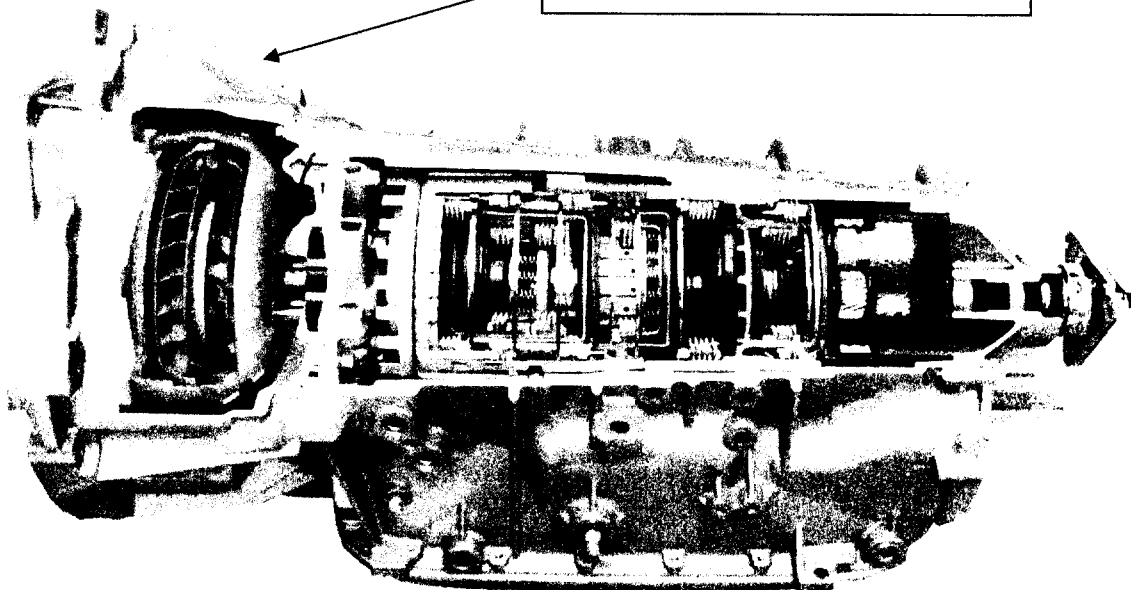

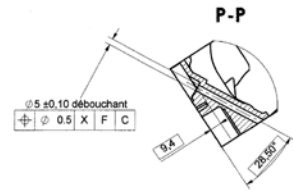
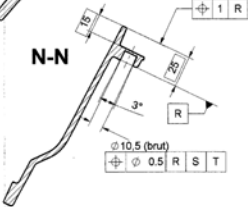
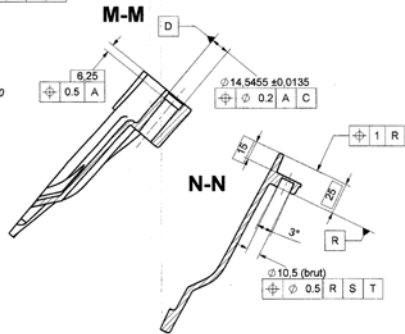
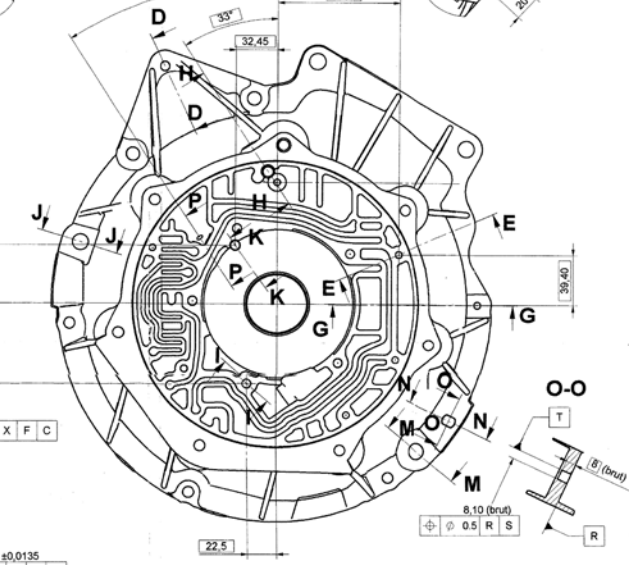
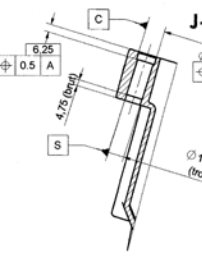
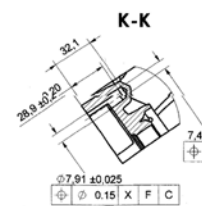
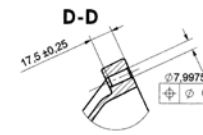
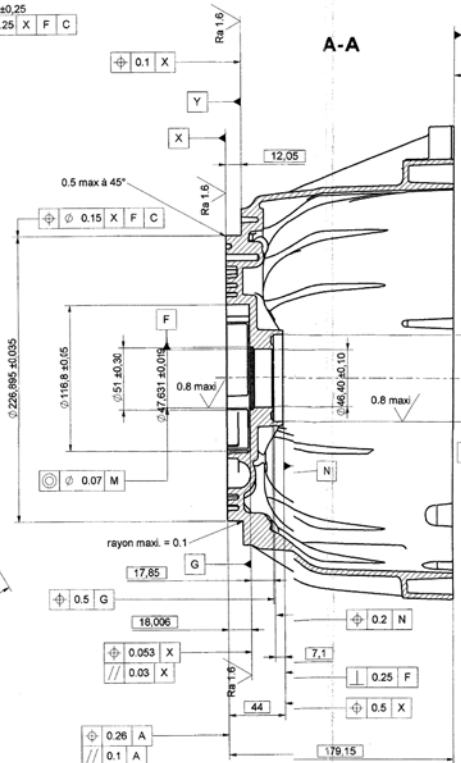
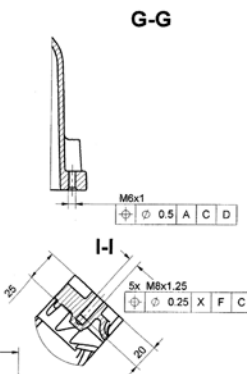
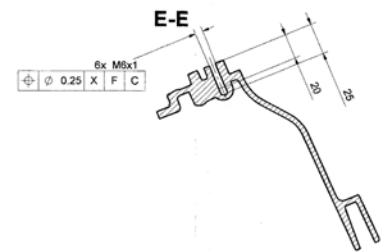
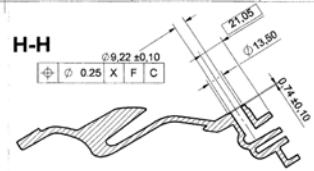
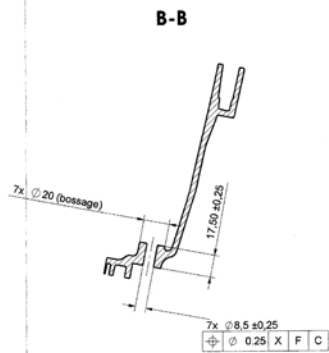
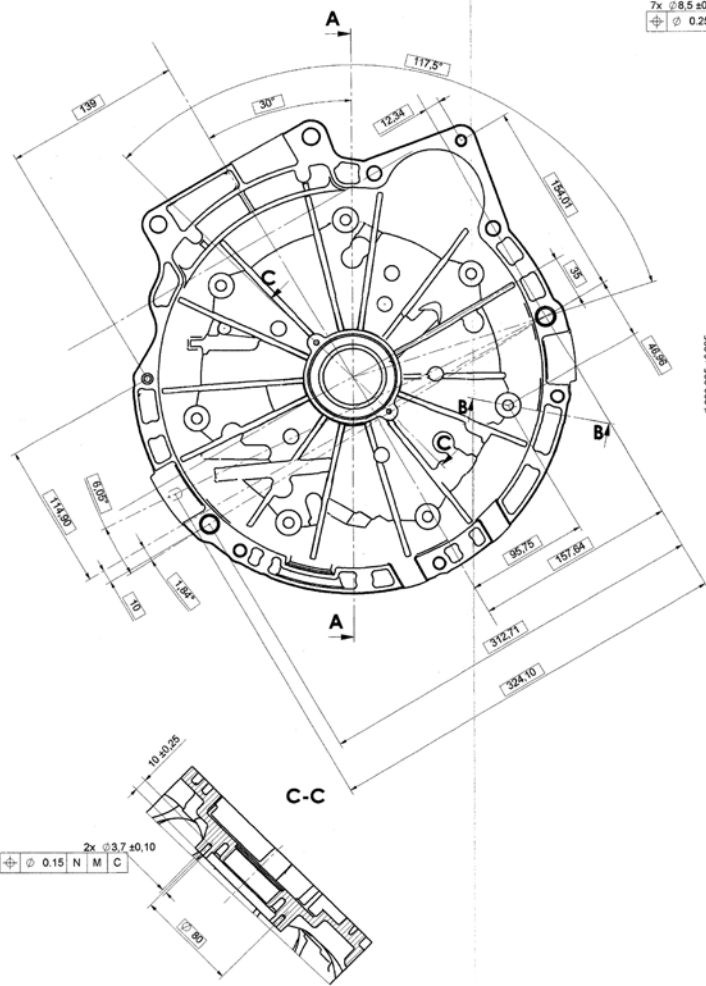

Cotation géométrique partielle
(toute forme non cotée est obtenue brut de fonderie)
Tolérancement ISO 8015
Tolérances générales ISO 2768mK

| | | | | |
|------------------------------------|----|-------------------------|------------------------|--------------|
| 1 | 1 | Carter Convertisseur | EN AB-44200 (Al Si 12) | Moulé |
| Rep | Nb | Désignation | Matériau | Observations |
| DOCUMENT TECHNIQUE DOC. DT2 | | | | |
| Dessiné par : | | Ensemble : | | |
| Le : 03 / 05 / 03 | | BOITE DE VITESSE | | |
| A1 Ech. : 1:2 | | Sous ensemble : | | |
| | | CONVERTISSEUR | | |

DT4 : Photos du CARTER BRUT et
Surfaces brutes de référence : R - S - T

