

DOSSIER RESSOURCE

EP3 3^{ème} Partie GESTION.

Ce sujet contient trois pages numérotées de 1/3 à 3/3

BEP Maintenance des Véhicules Automobiles opt° C Bateaux de Plaisance et Pêche	Code : 51 25 20C	Coéf : 1
EP3 3^{ème} Partie GESTION	SUJET	Page 1/3
Durée : 1H00	SESSION 2006	

NE RIEN ECRIRE DANS CETTE PARTIE

Composants électriques

-  Dielectric Grease (92-823506-1)
-  Loctite Pipe Sealant (92-809822)

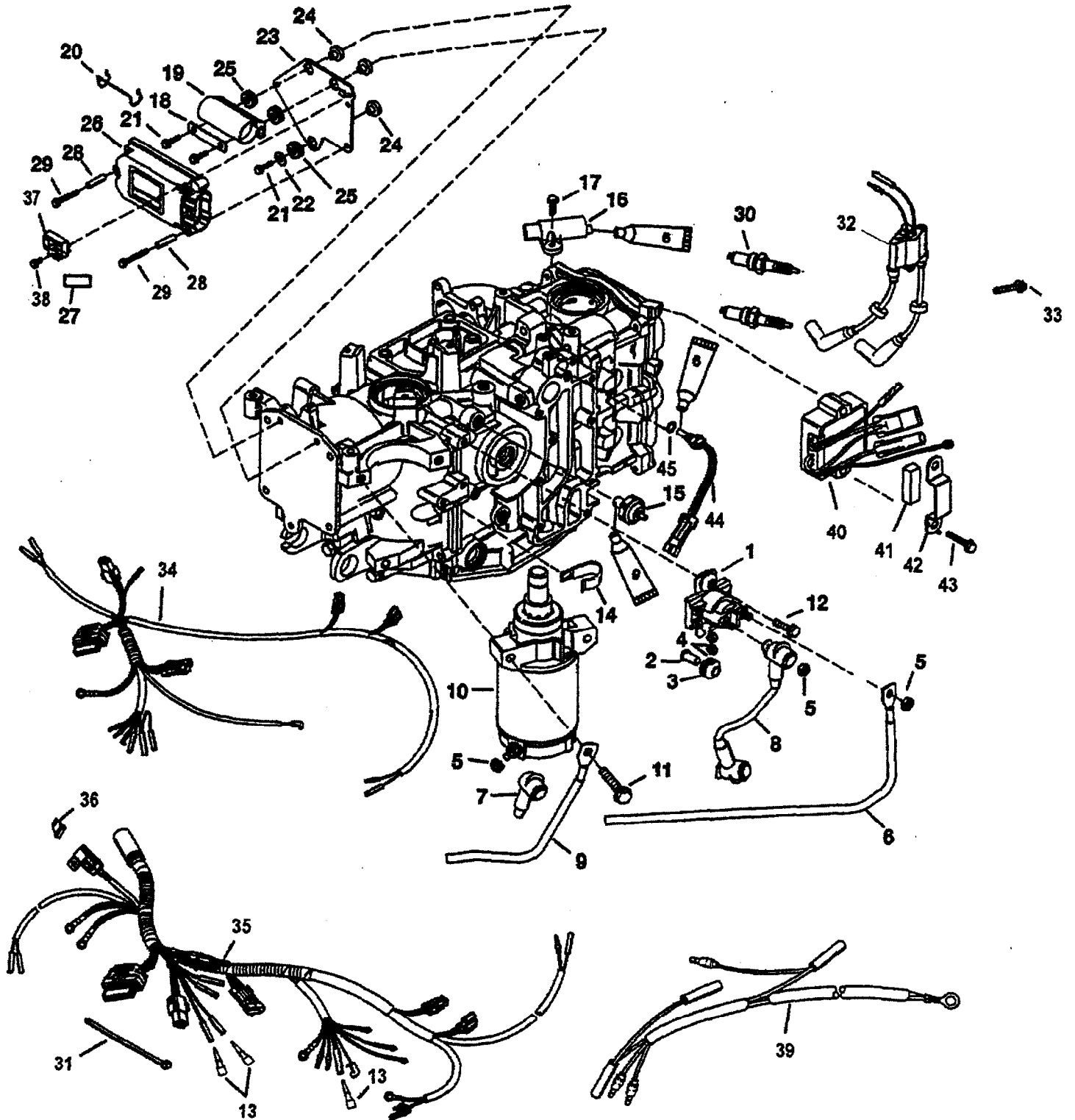

NE RIEN ECRIRE DANS CETTE PARTIE

Print Date: 11/02/05

EPC - Parts List

Version: 2.6.0

MERCURY (25 (4-STROKE)) Serial Nbr Range: 0P153500 AND UP (BEL)
 [90-803015 02], ELECTRICAL COMPONENTS

Ref	Class	Part	Description	Qty	Comment	Price HT
1	89	850187T 1	SOLENOID ASSEMBLY	1	(ELECTRIC)	26,5
2	23	818968	BUSHING	2	(ELECTRIC)	0,80
3	25	818967	GROMMET	2	(ELECTRIC)	15
4	11	26419	NUT (8-32)	2	(ELECTRIC)	0,86
5	11	94330	NUT (1/4-20)	3	(ELECTRIC)	0,86
6	84	88439A 9	BATTERY CABLE (POSTITIVE)	1	(ELECTRIC)	53
7	85	850067 1	INSULATOR BOOT (RED)	1	(ELECTRIC)	6
8	84	93388A13	CABLE	1	(ELECTRIC)	10
9	84	88439A 4	BATTERY CABLE (NEGATIVE)	1	(ELECTRIC)	53
10	50	859169T	STARTER MOTOR (SEE BREAKDOWN ON STARTER MOTOR)	1	(ELECTRIC)	200
11	10	40011153	SCREW (M8 X 45)	3	(ELECTRIC)	1,00
11	10	40011149	SCREW (M8 X 25)	1	(MANUAL)	1,00
12	10	826844 30	SCREW (M6 X 30)	2	(ELECTRIC)	1,00
12	10	824832 4	SCREW (M6 X 16)	1	(MANUAL)	1,00
13		13541	PLUG (MALE)	AR	(NON POWER TRIM)	0,50
14	54	55098	J CLIP	1	(MANUAL)	1,00
15	87	828040 1	PRESSURE SWITCH	1		25,00
16		828358	SENSOR-CRANK POSITION	1		35,00
17	10	40011107	SCREW (M5 X 16)	2		1,00
18		856040	BRACKET	1	(ELECTRIC)	1,00
19		856836	RETAINER	1	(ELECTRIC)	8,00
20		92753	RETAINER	1	(ELECTRIC)	4,50
21	10	821291 25	SCREW (M6 X 25)	3		1,00
22	12	40023 16	WASHER	3		1,00
23		856837	PLATE	1		1,00
24	23	826618	BUSHING	3		0,85
25	25	834985	GROMMET	3		0,85
26		878433A 1	ECM	1		650,00
27	37	825064	DECAL-CAUTION START IN GEAR	1		3,00
28	23	853920 1	BUSHING	3		0,85
29	10	821291 40	SCREW (M6 X 40)	3		0,85
30	33	827858	SPARK PLUG (NGK DPR6EA- 9)	2		7,50
31	54	816311T	STA-STRAP	AR		0,25
32	339	859738T 1	IGNITION COIL	1		198,00
33	10	826844 30	SCREW (M6 X 30)	2		0,85
34	84	859201T1	ENGINE HARNESS	1	(MANUAL)	45,00
35	84	859202T 2	ENGINE HARNESS	1	(ELECTRIC)	80,00
36	88	812619	FUSE (20 AMP)	1	(ELECTRIC)	1,35
37		828054	COVER	1	(ELECTRIC)	2,59
38	10	821291 10	SCREW (M6 x 10)	1	(ELECTRIC)	0,85
39	84	852375A 6	EXTENSION HARNESS	1	(ELECTRIC HANDLE)	35,00
40		883071T 1	VOLTAGE REGULATOR	1	(ELECTRIC)	125,00
41		830897 1	FOAM PAD	1	(ELECTRIC)	13,00
42		858413	BRACKET	1	(ELECTRIC)	1,88
43	10	824832 9	SCREW (M6 x 40)	2	(ELECTRIC)	0,85
44		858535	TEMPERATURE SENSOR	1		45,00
45	25	62702 1	O RING	1		0,95
-	61	854236T00	POWERHEAD	1		